

## Safety instructions

- Before using, check that your plug socket's voltage corresponds with the voltage on your device's label.
- Always connect your device to an earthed plug socket.
- If your device's power cable is damaged, it must be replaced by the manufacturer or customer service or another similarly qualified person to avoid any risks.
- Only use the device for its intended purpose and in a dry environment.
- Do not use the device on or in the vicinity of hot surfaces.
- Do not use any device with a damaged cable or plug or after it has malfunctioned or has fallen or been damaged in any other way. Send the device to the next authorised customer service to be checked, repaired or to have electrical or mechanical settings adjusted.
- Place the device on a flat surface or a table; do not let it hang over a table edge or counter edge.
- Make sure that the power cable does not touch any hot surfaces.
- Do not touch the device's hot surface (e.g. filter unit, hotplate, bottom of the water container).
- Do not immerse the device or power plug in water or other liquids in order to protect yourself against electric shocks.
- Do not use the device outside or in a hot environment.
- Do not pull the cable, wrap the cable around the device or bend the cable.
- Only use fresh (drinkable) and cold to luke-warm drinking water.
- Be aware of steam leaving the coffee filter container to avoid burns. Only use the device in line with the instructions.
- Do not use the device without water in the tank.
- Risk of burning; prepared coffee is hot.
- Do not clean the container with an aggressive cleaner, steel wool, or another abrasive material.
- Always pull out the power plug from the plug socket holding the actual plug, not the cable.
- Never use the device if the glass decanter (if any) is chipped. Only use the glass decanter (if any) provided with this device. Use it carefully as it is fragile.
- This device can be used by children from 8 years and by people with reduced physical, sensory or mental capabilities or a lack of experience and/or knowledge if he/she is supervised or has been instructed about the safe use of the device and have understood the resulting dangers.
- Children must not play with the

device. Cleaning and user-maintenance must not be carried out by children younger than 8 years without supervision.

- Children younger than 8 years should be kept away from the device and the power cable.
- This appliance is intended only for brewing coffee for use in households or similar non-commercial areas like shops, offices, and similar work environments, in agricultural establishments, by customers in hotels, motels, and other typical residential accommodation, or in bed and breakfast accommodation. Use the appliance according to the instructions given here. Improper use can cause hazards and can void any warranty claims. Observe the safety instructions.

### Symbols used

 Indicates a hazardous situation that can lead to injury or material damage.

 Please read all instructions carefully before using the appliance, and keep the operating instructions for later use.

### Table of contents

Safety instructions	1
Overview	3
Delivery content	3
Technical Data	3
Before first Use	3
Brewing coffee	4
Cleaning and Maintenance	5
Cleaning	5
Descaling	5
Warranty/Guarantee	6
Declaration of Conformity	6
Limitation of Liability	6
Disposal	6

## Overview

### Dear customer!

Congratulations on the purchase of your coffee maker Cafe Premium 4-Joy. Please read all instructions carefully before you use the appliance, and keep the operating instructions for later use.

### Delivery content

- 1 Lid
- 2 Water tank
- 3 Filter holder
- 4 Swiveling filter compartment
- 5 Glass decanter
- 6 Hot plate
- 7 ON/OFF button



### Technical Data

Model:	Cafe Premium 4-Joy
Type number:	CM42.001
Weight:	2.8 kg
Dimensions (L x W x H in mm):	241 x 195 x 410 mm
Rated voltage:	220 to 240 V AC
Frequency:	50/60 Hz
Rated power:	1800 W
Protection class:	I
Paper filter:	Size 4

### Before first use

Let coffee run through once. Discard the prepared coffee. Then clean the appliance as described in the chapter "Cleaning and maintenance".

## Brewing coffee

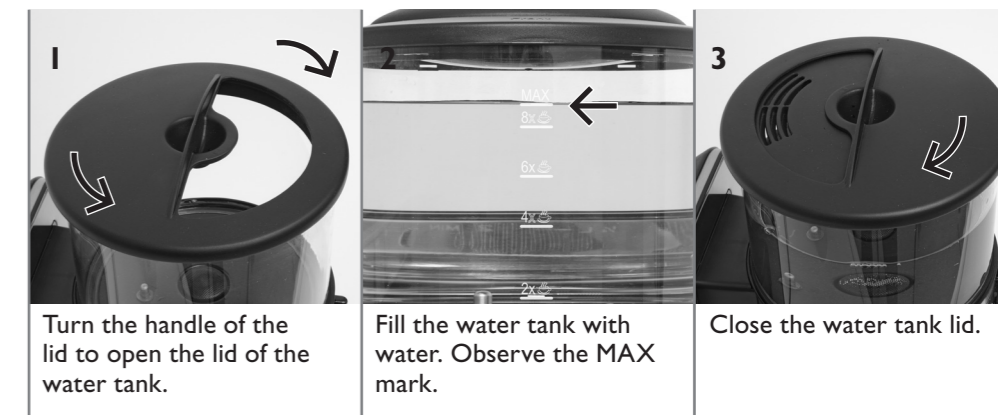

1 Turn the handle of the lid to open the lid of the water tank.



2 Fill the water tank with water. Observe the MAX mark.



3 Close the water tank lid.



4 Set the filter holder and a filter paper of size 4.



5 Fill the appropriate quantity of ground coffee into the filter. Use approx. 6 g of ground coffee per cup.



6 Set the glass decanter with closed lid onto the hotplate.



7 Press the  button once to start brewing. The blue pilot lamp lights.



8 Press the  button to stop brewing early. The pilot lamp goes out.

### Warning:

Do not open the lid of the water tank during the brewing process. The escaping steam can cause scalding. The glass decanter can be removed during brewing for a short time to pour coffee.

## Cleaning and Maintenance

### Cleaning



To clean the lid of the water tank: Turn the handle of the lid to align the two triangles and remove the upper part of the lid.

Remove the silicone plug to clean the water outlet under the water tank.

- Use a sponge or a cleaning brush to remove scale in the water tank. Do not use scratching or scoring objects or cleaning agents.
- Clean the glass decanter with warm water and a mild detergent.
- Clean the appliance with a slightly moistened, lint-free cloth. Do not insert it into water.
- Make sure all parts are completely dry.
- Please contact our customer service for spare parts and accessories.

### Descaling

The appliance must be descaled periodically, more frequently in households with hard water, less frequently in households with soft water, but at the latest after 50 brewing cycles.

1. Fill with water up to the max. mark with a descaling solution.
2. Start brewing.
3. Switch off the appliance after one half of the descaling solution has passed through. Let the solution act for approx. 10 minutes.
4. Continue brewing by switching on the appliance again, so that the remaining descaling solution can pass through.
5. Allow the appliance to cool for a few minutes.
6. Repeat brewing twice with fresh water.
7. Clean the appliance as described above.

### Warning:

Before cleaning, pull the plug and allow the appliance to cool down.



The heating plate in the water tank and the hotplate are coated with BIO-LON ceramics. Scratches on the coated surfaces are only optical and have no influence onto the BIO-LON sealing. They do not warrant a guarantee claim. Having excellent non-stick properties, BIO-LON ceramic coatings are free of PTFE and PFOA, and safe for foods.

### Declaration of Conformity

BEEM hereby declares that this appliance complies with the fundamental requirements and other relevant provisions of directives 2004/108/EC, 2006/95/EC, 2009/125/EC and 2011/65/EU.

### Warranty/Guarantee

In addition to the statutory warranty obligation, BEEM also grants an extended manufacturer's guarantee for some products. Provided this is granted, the corresponding details for each product can be found either on the product specific packaging, advertising material, or on the BEEM website for the respective product. You can find the detailed guarantee and warranty conditions, available accessories and spare parts, as well as operating instructions in various languages on our web page [www.beem.de](http://www.beem.de). Please contact your supplier if you have any questions on guarantee conditions, ordering accessories or service handling outside of Germany.

### Limitation of liability

We assume no liability for damage or follow up damage in the case of: Failure to observe the instructions in the user manual, use for other than the intended purpose, improper or unsuitable handling, incorrectly performed repairs, unauthorised modifications, use of non-approved parts or spare parts, use of unsuitable supplementary or accessory parts.

### Disposal

 The crossed-out wheeled bin logo requires the separate collection of waste electric and electronic equipment (WEEE). Electric and electronic equipment may contain dangerous and hazardous substances. Do not dispose of this appliance as unsorted municipal waste. Return appliance and packaging to a designated collection point for the recycling of WEEE. By doing so, you will help to conserve resources and protect the environment. Contact your retailer or local authorities for more information.

### BEEM Blitz-Elektro-Erzeugnisse Manufaktur Handels-GmbH

Dieselstrasse 19-21  
61191 Rosbach v.d.H.  
Deutschland

Email [kundenservice@beem.de](mailto:kundenservice@beem.de)  
Web [www.beem.de](http://www.beem.de)  
Tel. +49 (0)60 03-91 13 88 88  
Fax +49 (0)60 03-91 13 99 99

© BEEM GmbH

All rights reserved.  
Reprinting permitted only with  
approval of the publisher.  
Technological changes and  
misprints excluded!



Cafe Premium 4-Joy\_CM42.001\_V1.1\_K2\_15-09-30

## Operating Instructions EN

# Cafe Premium 4-Joy

Coffee maker

